



JYVÄSKYLÄN YLIOPISTO
UNIVERSITY OF JYVÄSKYLÄ

LÄHDE

YOUR SOURCE FOR KNOWLEDGE

JYVÄSKYLÄ UNIVERSITY
LIBRARY LÄHDE

The Jyväskylä University Library

Lähde is the gateway to a unique university campus and the world of science, learning and well-being.

Where art and science meet

THE ARCHITECTURE OF LÄHDE

The Main Library of the University of Jyväskylä was designed by architect Arto Sipinen (1936–2017). The building is an integral part of the administration and department buildings on the Seminaarinmäki campus. Upon its completion in 1974, the modern library building represented a new kind of library architecture. Books were placed in large reading halls where users could access them freely. Spaces designed for groupwork were another new element.

Together with interior architects Vuokko and Torsten Laakso, Sipinen designed the Library as a holistic work of art. The colour yellow recurred in the construction elements and furniture in combination with blue, white, and black.

The main designer of the comprehensive renovation, which was completed in 2021, was Arto Sipinen's son, architect Ari Sipinen. The facilities of the Library building were transformed to meet the University's current needs, but the original colour palette was preserved alongside the characteristic ambience of the entrance hall, with its large windows and abundance of natural light.

ART IN LÄHDE

Lähde features artworks from both national collections as well as the University's own. The centerpiece is a work

commissioned by the government from sculptor Mikael Pohjola. It depicts the development of the University of Jyväskylä from Finland's first teacher seminary, founded by Uno Cygnaeus, into a modern multidisciplinary university. Some of the artworks have been originally acquired for the building. In the entrance hall, there is a conserved mural *Minä olen väri ja sinä olet sana [I am a colour and you are a word]* by Carolus Enckell (1975). The different floors of Lähde also feature enlarged images from the photo archive of the the Jyväskylä University Museum. These illustrate student life and the atmosphere on campus throughout the decades.

EVENT AND EXHIBITION SPACES

The event and exhibition space Tietoniikka and the science education space Taitoniikka are located on the first floor. These spaces host events, exhibitions, and workshops where people can learn about current issues and trends in arts and science. Taitoniikka serves as a venue for, among others, JYUniors, which provides science education for children and young people, as well as the University of the Third Age. The arts and science events in Lähde are open for all.

Jyväskylä: the home of arts and science

The country's first teacher seminary to train Finnish-speaking primary school teachers was established in Jyväskylä in 1863. The town became a centre of Fennoman ideology and the Finnish language, one of the key figures of which was district physician Wolmar Schildt (1810–1893).

As a homage to Schildt, the Café Tiede, the Taide campus restaurant as well as various teaching and meeting facilities in Lähde have been named after some of the Finnish words he coined. The names for the teaching facilities on the third floor come from the names of waterways.

NAMING CONTEST

An open contest was held to name the renovated Library building. *Lähde* is a beautiful Finnish word that means 'spring' or 'source'. Its meanings resonate with the renovated building in multiple ways: it is a source of knowledge as well as a welcoming and invigorating space for meeting and nurturing community.





**YELLOW LIBRARY:
A VIRTUAL TOUR**

Take a look at the Library building as it was before the renovation. The Yellow Library online exhibition takes you on a 360-degree virtual tour. It shares the history of the building, describes its architecture, and explains how the Library works.

» keltainenkirjasto.jyu.fi

Services

Open Science Centre

THE JYVÄSKYLÄ UNIVERSITY LIBRARY is a public scientific library. It is a modern hub for learning and working, offering high-quality scientific materials to support learning, teaching, and research. The Library's collections are available for all customers.

The Jyväskylä University Library is one of the six legal deposit libraries in Finland. The legal deposit collection Fennica is an archived collection of Finnish publications, including audio and visual records, such as the national radio and television archive. The Library services are located on the two lower levels of the building.

THE JYVÄSKYLÄ UNIVERSITY MUSEUM presents and preserves the University's cultural and scientific heritage from the time of the teacher seminary up to the present day. The Museum's photo archive is located in the Library building, while the artifact and archive collections are stored in the Kanavuori collection centre. Exhibitions are arranged at the Soihtu Exhibition Centre in Seminaarinmäki and also in the Natural History Museum at Vesilinna as well as in the Tietoniekka exhibition space in the Library building. To access the collections, please contact the University Museum. The Museum also welcomes additional material related to the University and its previous incarnations.

OPEN SCIENCE AND RESEARCH SERVICES support researchers and students in issues pertaining to scientific publishing, management of research data as well as the visibility and impact of research.

- kirjasto.jyu.fi
- tiedemuseo.jyu.fi
- jyu.fi/studentlife
- jyu.fi/digipalvelut
- compass-group.fi

Science for All

The University's Science for All programme welcomes everybody to the University. Science events, workshops, public lectures and exhibitions introduce people to the world of science, art and research.

→ jyu.fi/tiedettakaikille

Student Life

The University of Jyväskylä Student Life helps students with well-being in their studies and daily life. At the same time it supports them in developing their study skills. Student Life facilities are located on the second floor of the Library building.

Digital Services

JYU Digital Services support students, staff and visitors in their digital needs while developing and maintaining the University's digital infrastructure. The Digital Services helpdesk is located on the third floor of the Library building.

Taide campus restaurant

Taide welcomes JYU staff and students as well as other customers to enjoy healthy meals prepared from the best seasonal ingredients. Takeaway is also available.

Café Tiede

Café Tiede is a stylish but relaxed meeting place that offers a place to take a break and recharge after work and studies. All Library visitors are welcome.



Maps

3



SPACES

- B346.3 Studio
Digital Services: Customer Service
Service
Workspace, Digital Services
- B345.1 Conference Room
- B347 Koski
- B348 Puro
- B349 Suvanto
- B339 Virta

ART

- 1 Outi Pieski:
Gámasvárri fjeld, 2014
- 2 Ilkka Väätti:
Serigraphy series, 1994
- 3 Oiva Meriläinen:
Metsä [Forest], 1983
- 4 An enlarged historical black and white photo

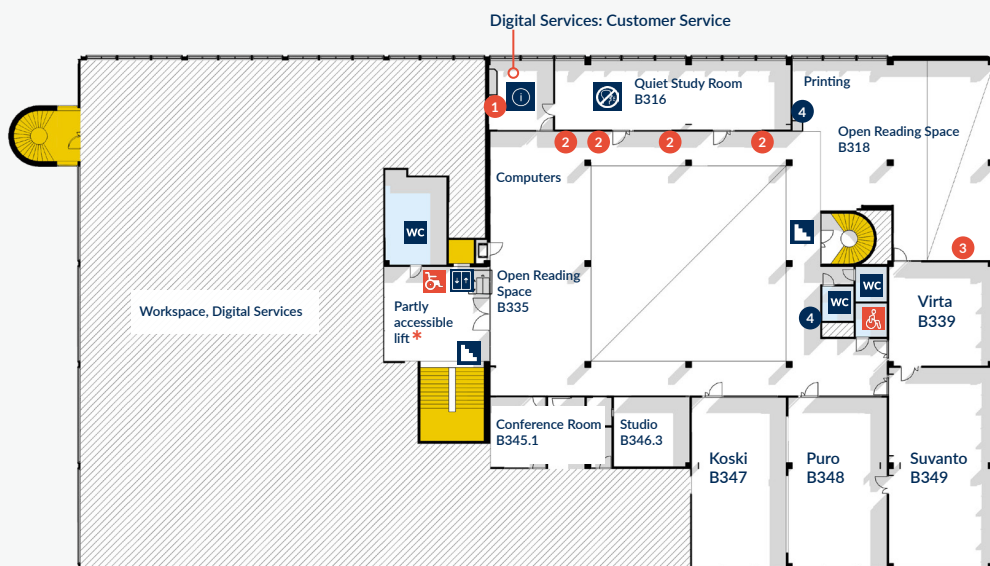

* The depth of the lift car is a few centimetres short of a fully accessible solution where the standard depth is 140 cm. When necessary, please contact the maintenance managers of the Library building.

2



SPACES

	Workspace, Open Science Centre
	Museum Services
B246.3	Conference Room
B247	Päätelmä
B249	Suure
B239	Särmiö
B248	Väite
	Student Life: Student well-being

ART

- 1 Aino-Kaarina Pajari:
Pippurihelmet [Pepper pearls], 2011
- 2 Markku Kolehmainen:
Täydellinen lehmänkäännös [Total reversal], 1992
- 3 Mikael Pohjola:
Ex Libris, 2022
- 4 Leena Turpeinen:
Kriitikko [Critic], 1975
- 5 Aiko Tsukahara:
Cloud, 2012
- 6 An enlarged historical black and white photo

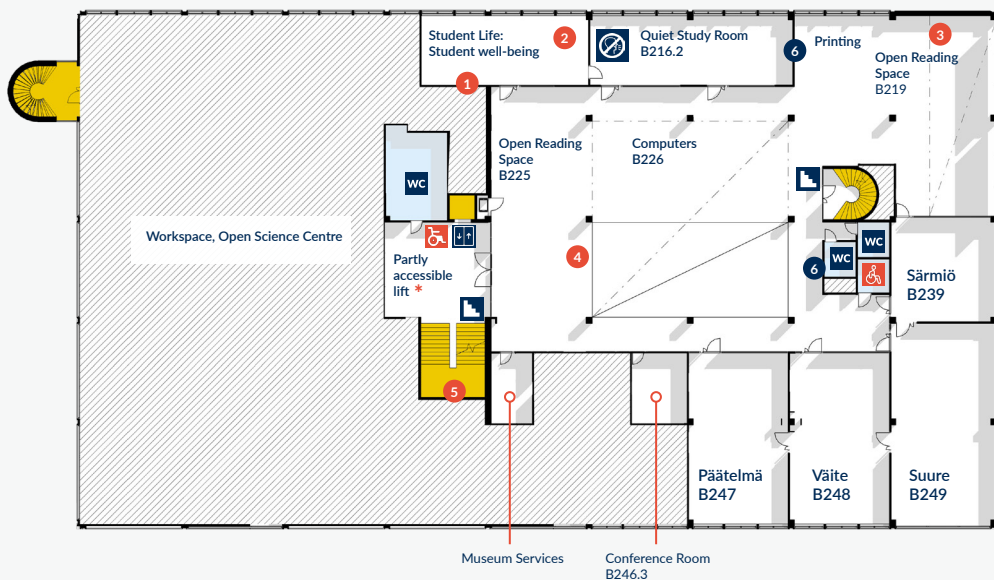

* The depth of the lift car is a few centimetres short of a fully accessible solution where the standard depth is 140 cm. When necessary, please contact the maintenance managers of the Library building.

1



SPACES

- T131.3 EXAM Room
- B147 Café Tiede
- B154 Conference Room
- B116 Exhibitions and Events
- B118.1 Study Room
- B131 Campus restaurant Taide

ART

- 1 Mika Hytti:
Kinesis, 2019
- 2 Sanna Kannisto:
Approach of Winter, 2018
- 3 Heli Hiltunen:
Yksi ainoa nyt [One single now],
2005–2007
- 4 Carolus Enckell:
Minä olen väri ja sinä olet sana
[I am a colour and you are a word], 1975
- 5 An enlarged historical black and white photo

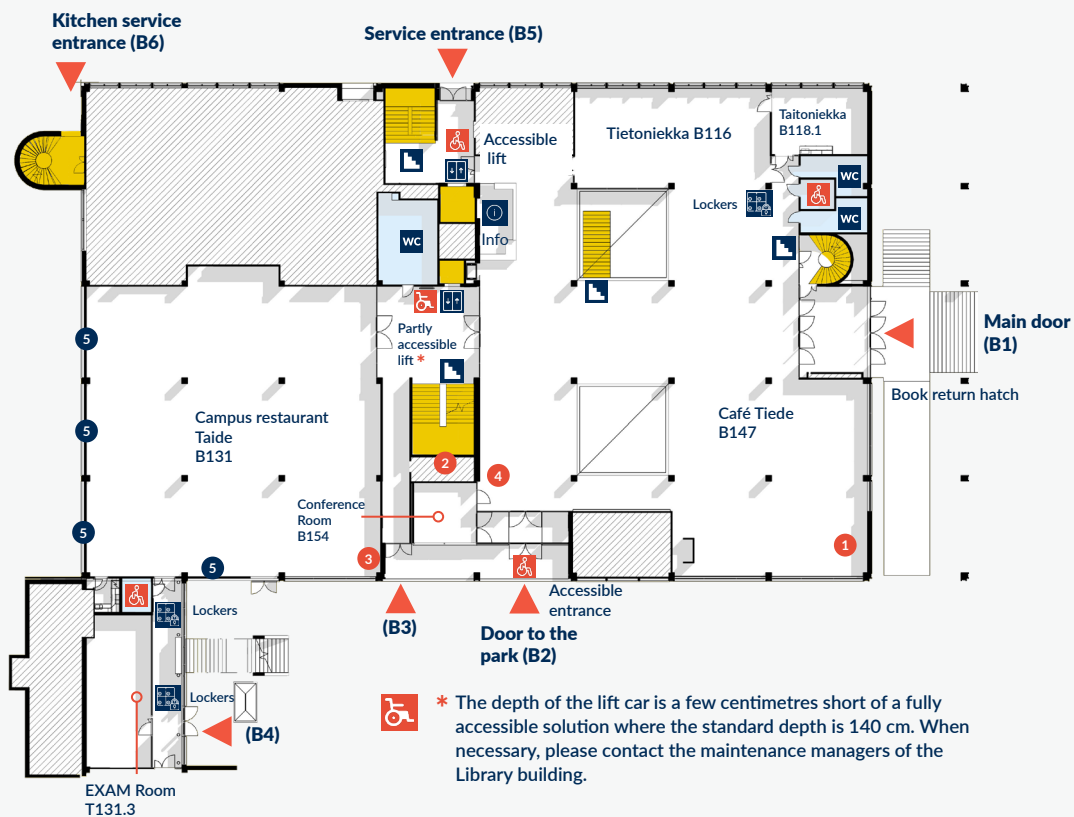

-1



SPACES

- BYP23.1 Student Lounge**
Library
/ Customer Service
/ Loans
/ Returns
Group Study Rooms
- BYP43 Studio**
- BYP55.2 Study Room**

ART

- 1 Tuula Lehtinen:**
Pohjoisseinältä, [From the northern wall], 1984
- 2 Riitta Uusitalo:**
Vaajakosken liikenneympyrä, [Vaajakoski roundabout], 2017
- 3 Jenni Karhapää:**
Viimeinen parkkipaikka, [The last parking space], 2018
- 4 An enlarged historical black and white photo**



* The depth of the lift car is a few centimetres short of a fully accessible solution where the standard depth is 140 cm. When necessary, please contact the maintenance managers of the Library building.

-2



SPACES

Library
/ Course Books
/ Loans
/ Journals
/ Research Literature
Group Study Rooms
Research Room

ART

- 1 Jorma Hautala:
Lyyrinen akseli [Lyric axis], 1978
- 2 Voitto Kantokorpi:
S & B 30, 1990
- 3 An enlarged historical black and white photo

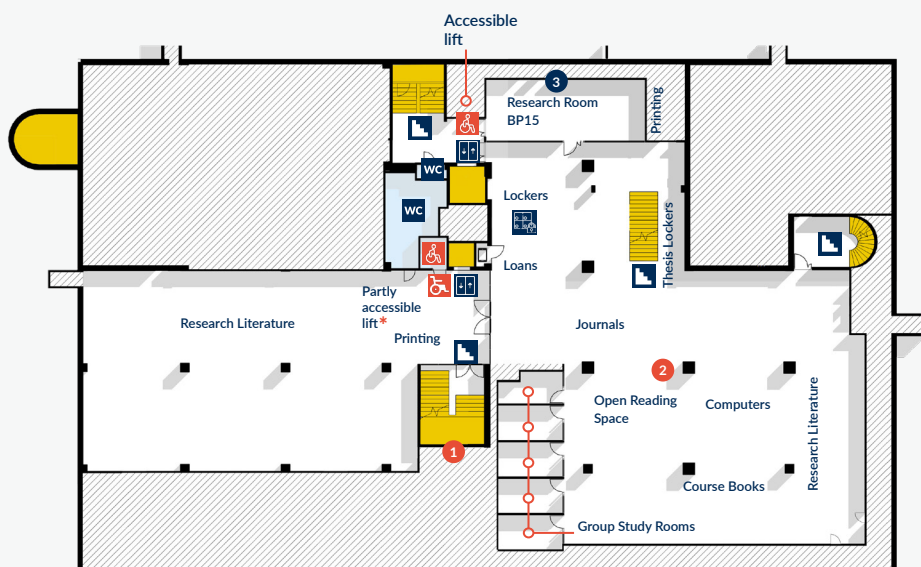

* The depth of the lift car is a few centimetres short of a fully accessible solution where the standard depth is 140 cm. When necessary, please contact the maintenance managers of the Library building.



JYVÄSKYLÄN YLIOPISTO
UNIVERSITY OF JYVÄSKYLÄ

Library building opening hours

Mon–Fri 7:30 a.m.–9 p.m.

Sat 7:30 a.m.–5 p.m.

Sun 11 a.m.–4 p.m.

Jyväskylä University Library

KIRJASTO.JYU.FI

JYKNEUVONTA@LIBRARY.JYU.FI

TEL. 040 805 3803 (DURING SERVICE HOURS)

Science for All and Tietoniekka

TIEDETTAKAIKILLE@JYU.FI

Museum services

KAMPUSMUSEO@JYU.FI

Library building maintenance managers

VAHTIMESTARIT-SEMINAARINMAKI@JYU.FI

TEL. 050 428 5237